

**EAST MIDLANDS GATEWAY**  
**RAIL FREIGHT INTERCHANGE**

**TRAFFIC MANAGEMENT**

**Planned Works and Night  
Closures Review**

- **W/C Mon 20<sup>th</sup> Nov 17**
- **W/C Mon 27<sup>th</sup> Nov 17**
- **W/C Mon 4<sup>th</sup> Dec 17**



Updated Tuesday 15<sup>th</sup> Nov 17

# EAST MIDLANDS GATEWAY – W/C 20th Nov Oct 17



M1 Junc 24a Southbound exit Slip lane 2 closure 24/7

Warren Lane Bridge  
Two way Lights

50MPH A50 N/B 24/7  
Jnc 24 to Main St

M1 Junc 24 Southbound Slip Hard Shoulder closure 24/7  
M1 Junc 24 Southbound Slip Lane 1 closure Daytime Off  
Peak 0930 -1530hrs

**Junc 24 Roundabout.  
Various night time lane  
closures 20<sup>th</sup> – 25<sup>th</sup> Nov**

Junction 24 - see Enlarged sheet

50 MPH on A453 jnc24  
to Finger farm rd-ab.

A453 Dual Carriageway Open daytime .  
Ashby Road Closed  
North Bound Night closures Mon 20<sup>th</sup> – Friday 24<sup>th</sup>  
Nov 2100 – 0600  
South Bound Lane 2 open only Mon 20<sup>th</sup> – Friday 24<sup>th</sup>  
Nov 2100 – 0600



# Junction 24– W/C Mon 20<sup>th</sup> Nov 17

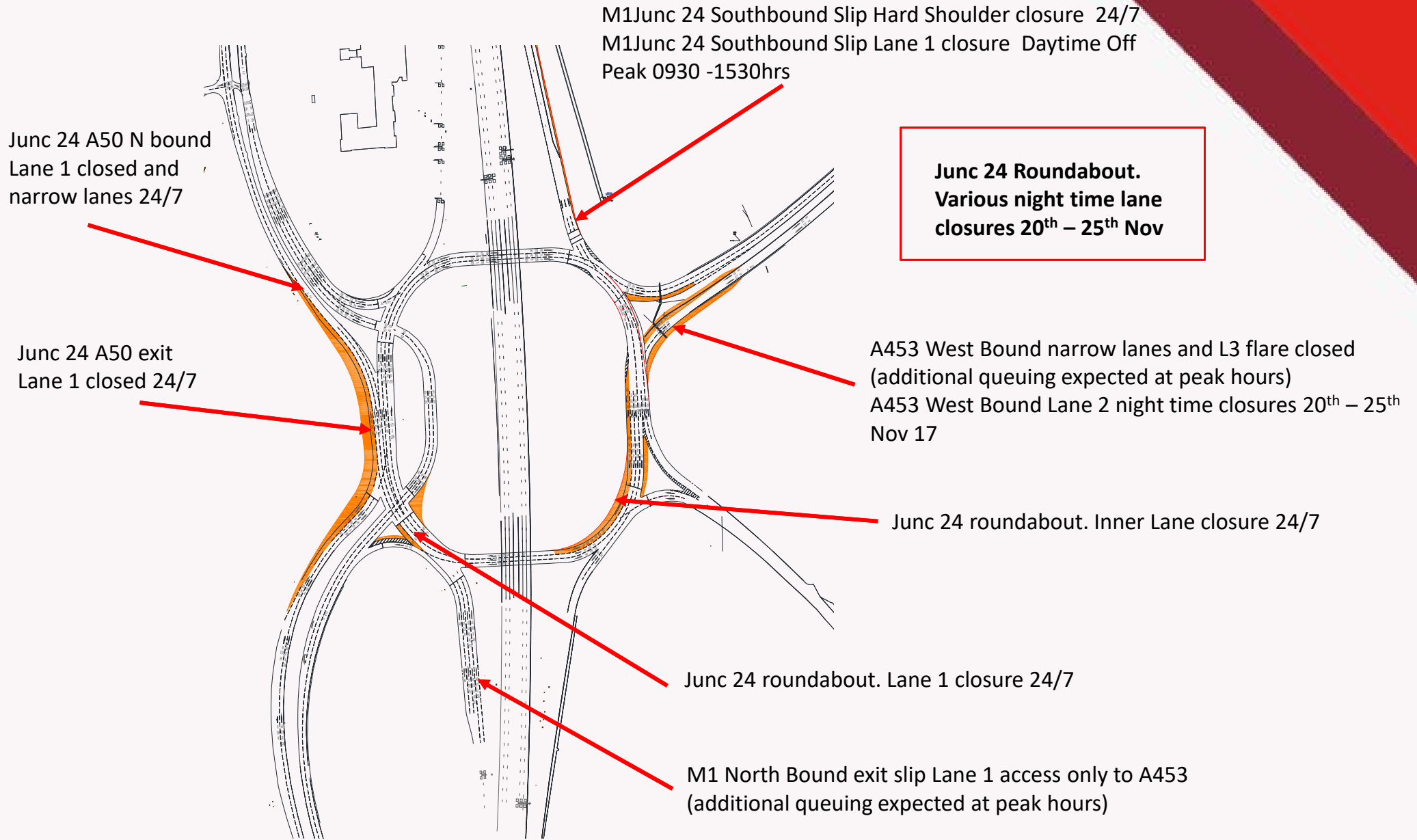

# EAST MIDLANDS GATEWAY – W/C 27th Nov Oct 17



M1 Junc 24a Southbound exit Slip lane 2 closure 24/7

Warren Lane Bridge  
Two way Lights

50MPH A50 N/B 24/7  
Jnc 24 to Main St

M1 Junc 24 Southbound Slip Hard Shoulder closure 24/7  
M1 Junc 24 Southbound Slip Lane 1 closure Daytime Off  
Peak 0930 -1530hrs

**Junc 24 Roundabout.  
Various night time lane  
closures 27<sup>th</sup> – 1<sup>st</sup> Dec**

Junction 24 - see Enlarged sheet

50 MPH on A453 jnc24  
to Finger farm rd-ab.

A453 Dual Carriageway Open daytime .  
Ashby Road Closed  
Night time closure Mon 27th Nov 17 2100 - 0600  
Lane closures 28th – 30<sup>th</sup> Nov 17 2100 - 0600

Radisson Blu Hotel,  
East Midlands Airport  
Modern pick with...

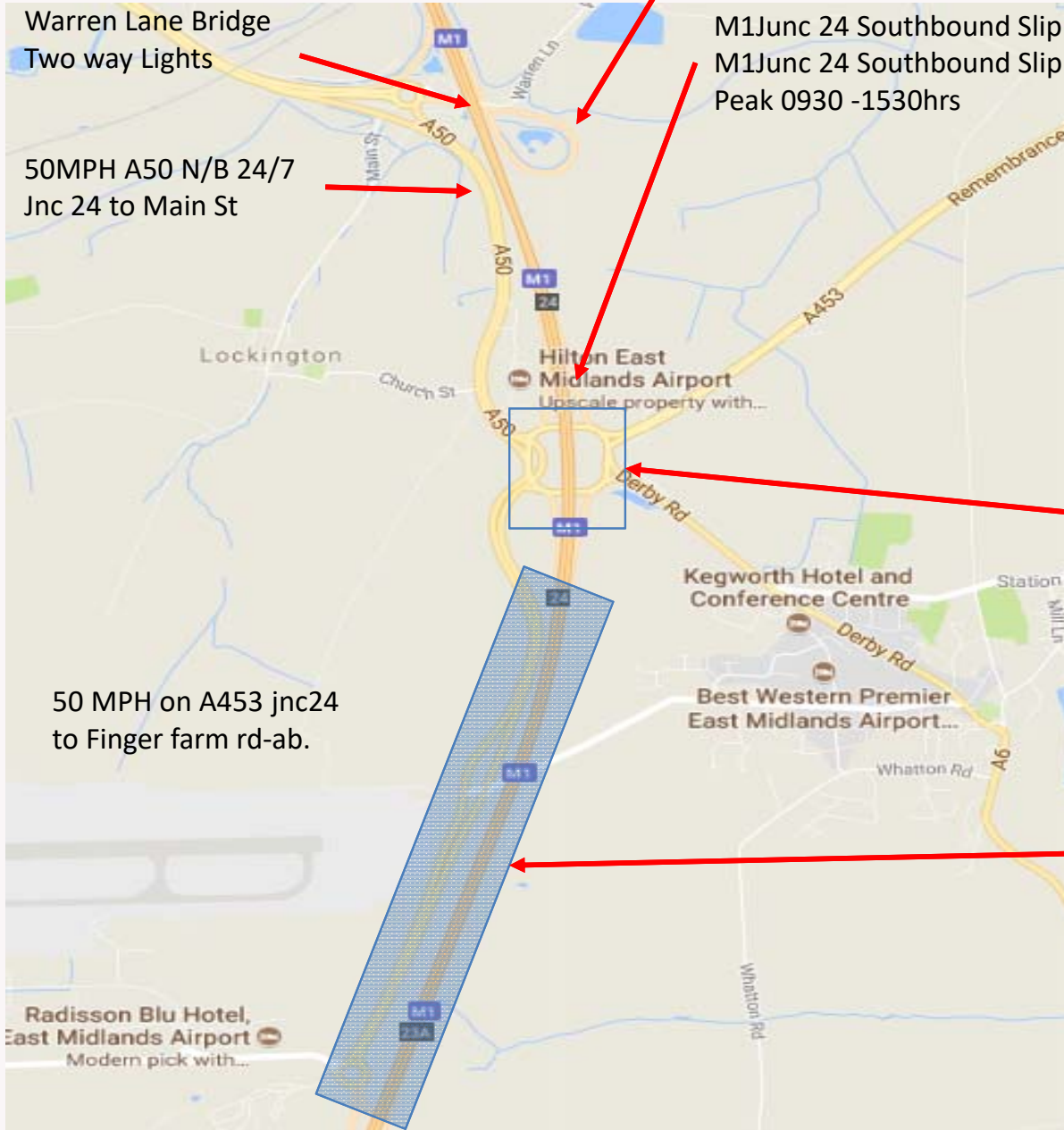

# Junction 24– W/C Mon 27<sup>th</sup> Nov 17

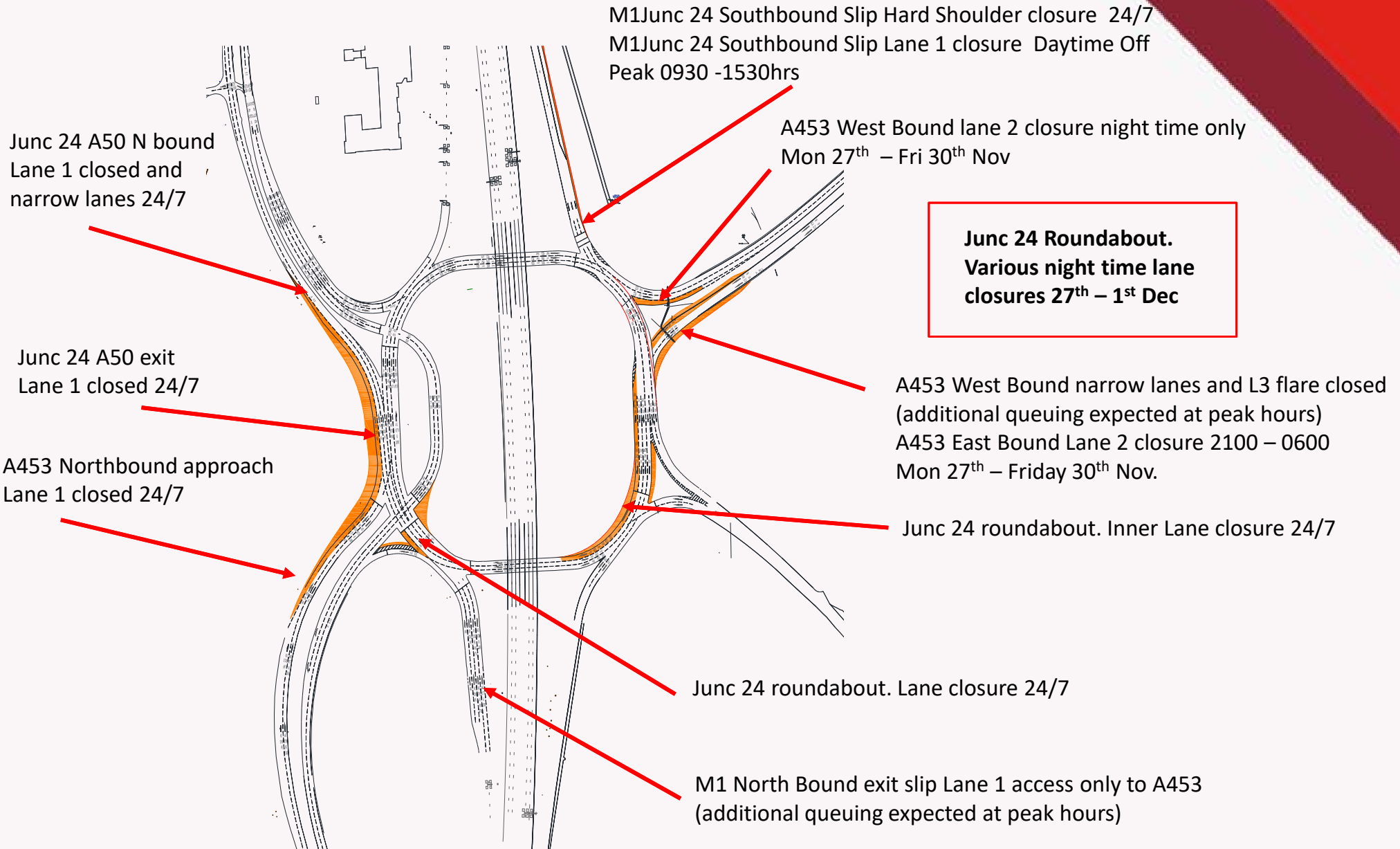

# EAST MIDLANDS GATEWAY – W/C 4<sup>th</sup> Dec 17



M1 Junc 24a Southbound exit Slip lane 2 closure 24/7

Warren Lane Bridge  
Two way Lights

50MPH A50 N/B 24/7  
Jnc 24 to Main St

M1 Junc 24 Southbound Slip Hard Shoulder closure 24/7  
M1 Junc 24 Southbound Slip Lane 1 closure Daytime Off  
Peak 0930 -1530hrs

Junc 24 Roundabout.  
Various night time lane  
closures 4<sup>th</sup> – 9<sup>th</sup> Dec

Junction 24 - see Enlarged sheet

50 MPH on A453 jnc24  
to Finger farm rd-ab.

A453 Dual Carriageway Open daytime .  
Night closures 4<sup>th</sup> – 9<sup>th</sup> Dec 2100 - 0600

Radisson Blu Hotel,  
East Midlands Airport  
Modern pick with...



# Junction 24– W/C Mon 4<sup>th</sup> Dec 17

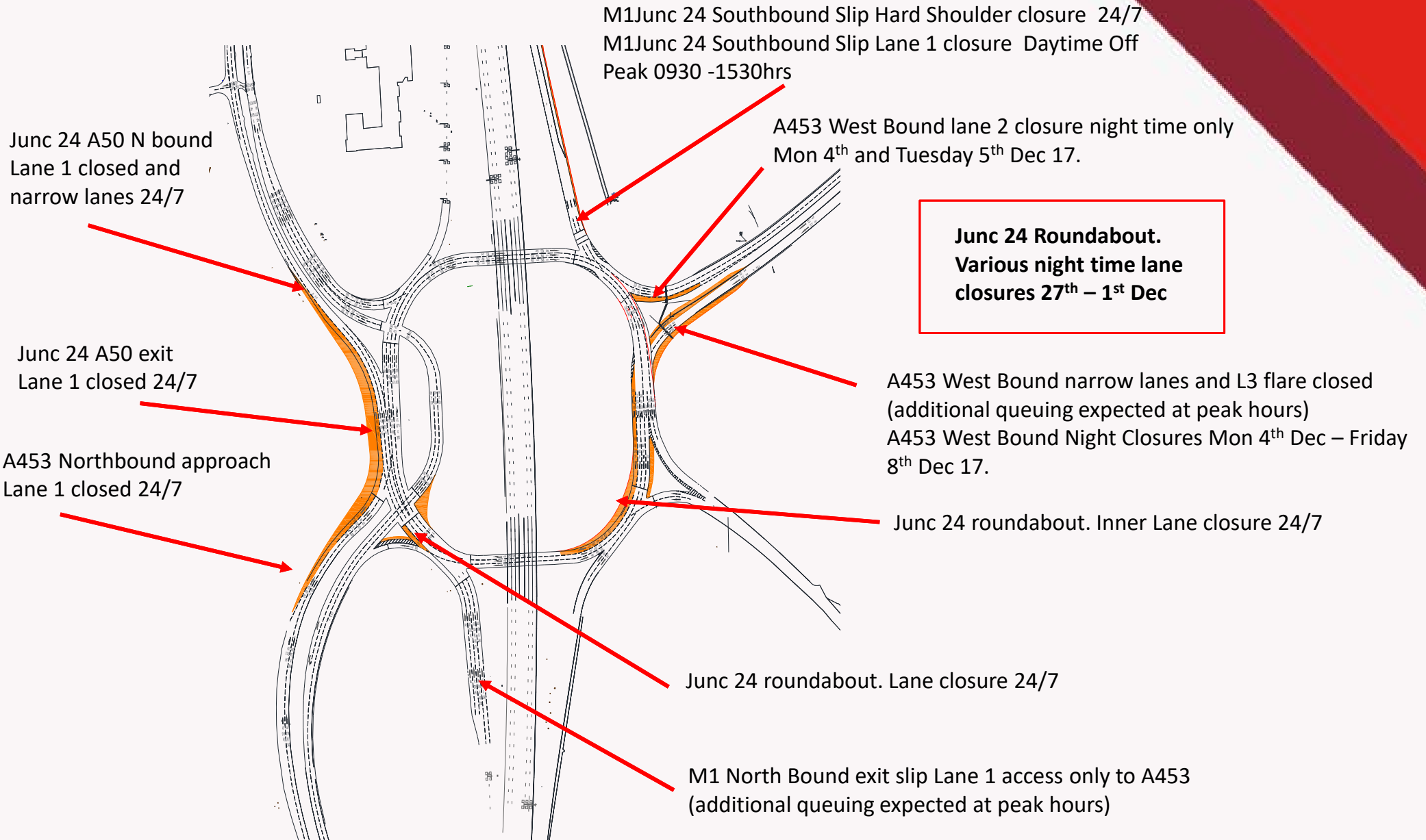

# Further Information

## Contacts,

Tel EMG Enquiries  
- 07514227681

E-mail  
- [emg-enquiries@winvic.co.uk](mailto:emg-enquiries@winvic.co.uk)

Web East Midlands Gateway specific  
- [www.eastmidlandsgateway.co.uk/community/travel.php](http://www.eastmidlandsgateway.co.uk/community/travel.php)

Web on the day of travel  
- [www.roadworks.org/](http://www.roadworks.org/)  
- [www.trafficengland.com/](http://www.trafficengland.com/)

## Project updates,

A project update if you wish to be added please e-mail request to above address.

This will include an overall project update and detailed traffic management plans for the forthcoming weeks including dates and times.

Please note all dates within this document are to be confirmed closer to the time