

# EAST MIDLANDS GATEWAY

## RAIL FREIGHT INTERCHANGE

# TRAFFIC MANAGEMENT

## Planned Works and Night Closures Review

- W/C Mon 30<sup>th</sup> Oct 17
- W/C Mon 13<sup>th</sup> Nov 17
- W/C Mon 20<sup>th</sup> Nov 17
- W/C Mon 27<sup>th</sup> Nov 17



**winvic**

[winvic.co.uk](http://winvic.co.uk)

# EAST MIDLANDS GATEWAY – W/C Mon 30th Oct 17



M1 Junc 24a Southbound exit Slip lane 2 closure 24/7



Warren Lane Bridge  
Two way Lights

50MPH A50 N/B 24/7  
Jnc 24 to Main St

50 MPH on A453 jnc24  
to Finger farm rd-ab.

Radisson Blu Hotel,  
East Midlands Airport  
Modern pick with...

M1Junc 24 Southbound Slip Hard Shoulder closure 24/7  
M1Junc 24 Southbound Slip Lane 1 closure Daytime Off  
Peak 0930 -1530hrs

Junction 24 - see Enlarged sheet

A453 contraflow 24/7 & Ashby Road closed.  
Contraflow Northbound  
Night Closure Mon 30<sup>th</sup> Oct – Thursday

**Junc 24  
Roundabout.  
Various night time  
lane closures**

# Junction 24 – W/C Mon 30th Oct 17

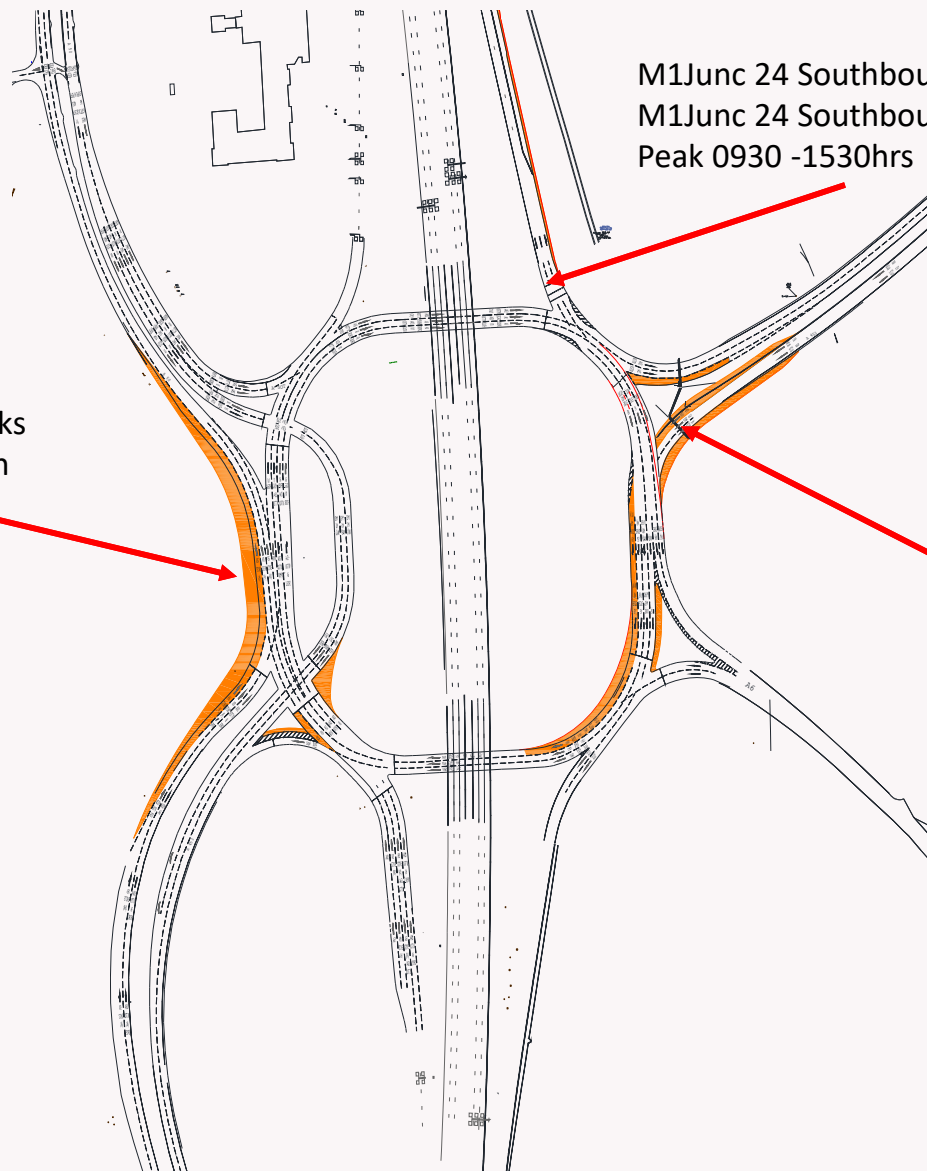

M1Junc 24 Southbound Slip Hard Shoulder closure 24/7  
M1Junc 24 Southbound Slip Lane 1 closure Daytime Off  
Peak 0930 -1530hrs

Offline verge works  
for A453-A50 turn

A453 West Bound narrow lanes and L3 flare closed  
(additional queuing expected at peak hours)

# EAST MIDLANDS GATEWAY – W/C 6th Nov Oct 17



M1 Junc 24a Southbound exit Slip lane 2 closure 24/7



Warren Lane Bridge  
Two way Lights

50MPH A50 N/B 24/7  
Jnc 24 to Main St

50 MPH on A453 jnc24  
to Finger farm rd-ab.

Radisson Blu Hotel,  
East Midlands Airport  
Modern pick with...

M1 Junc 24 Southbound Slip Hard Shoulder closure 24/7  
M1 Junc 24 Southbound Slip Lane 1 closure Daytime Off  
Peak 0930 -1530hrs

**Junc 24**  
**Roundabout.**  
**Various night time**  
**lane closures**

Junction 24 - see Enlarged sheet

A453 contraflow 24/7 & Ashby Road closed.  
Single Lane running North and Southbound  
Night closures Mon 6th – Friday 10<sup>th</sup> Nov

# Junction 24 – W/C Mon 6<sup>th</sup> Nov 17

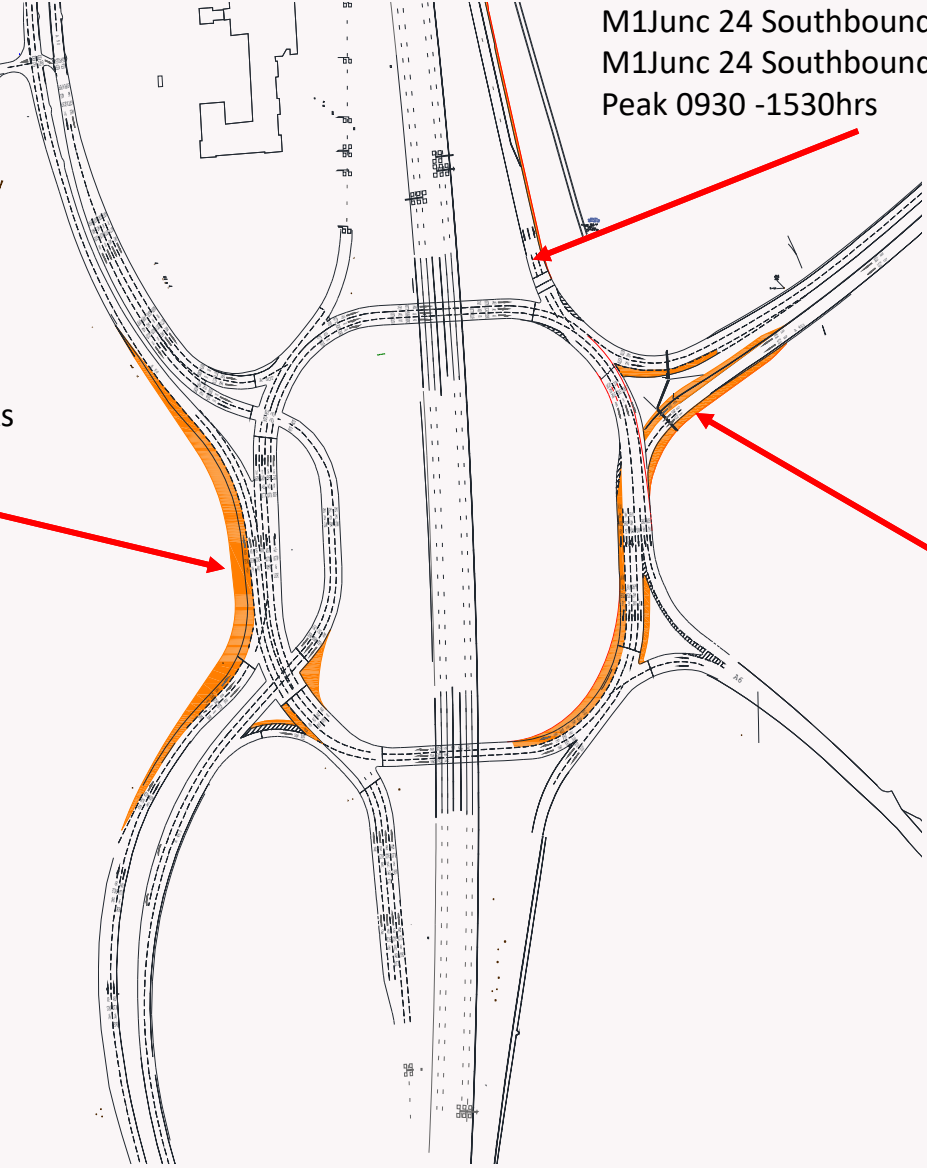

M1Junc 24 Southbound Slip Hard Shoulder closure 24/7  
M1Junc 24 Southbound Slip Lane 1 closure Daytime Off  
Peak 0930 -1530hrs

Offline verge works  
for A453-A50 turn

A453 West Bound narrow lanes and L3 flare closed  
(additional queuing expected at peak hours)

# EAST MIDLANDS GATEWAY – W/C 13th Nov Oct 17



M1 Junc 24a Southbound exit Slip lane 2 closure 24/7

Warren Lane Bridge  
Two way Lights

50MPH A50 N/B 24/7  
Jnc 24 to Main St

M1 Junc 24 Southbound Slip Hard Shoulder closure 24/7  
M1 Junc 24 Southbound Slip Lane 1 closure Daytime Off Peak 0930 -1530hrs

**Junc 24  
Roundabout.  
Various night time  
lane closures**

**Junction 24 - see Enlarged sheet**

50 MPH on A453 jnc24  
to Finger farm rd-ab.

A453 Open. Ashby Road closed.  
Night closures Mon 13th – Friday 17<sup>th</sup> Nov

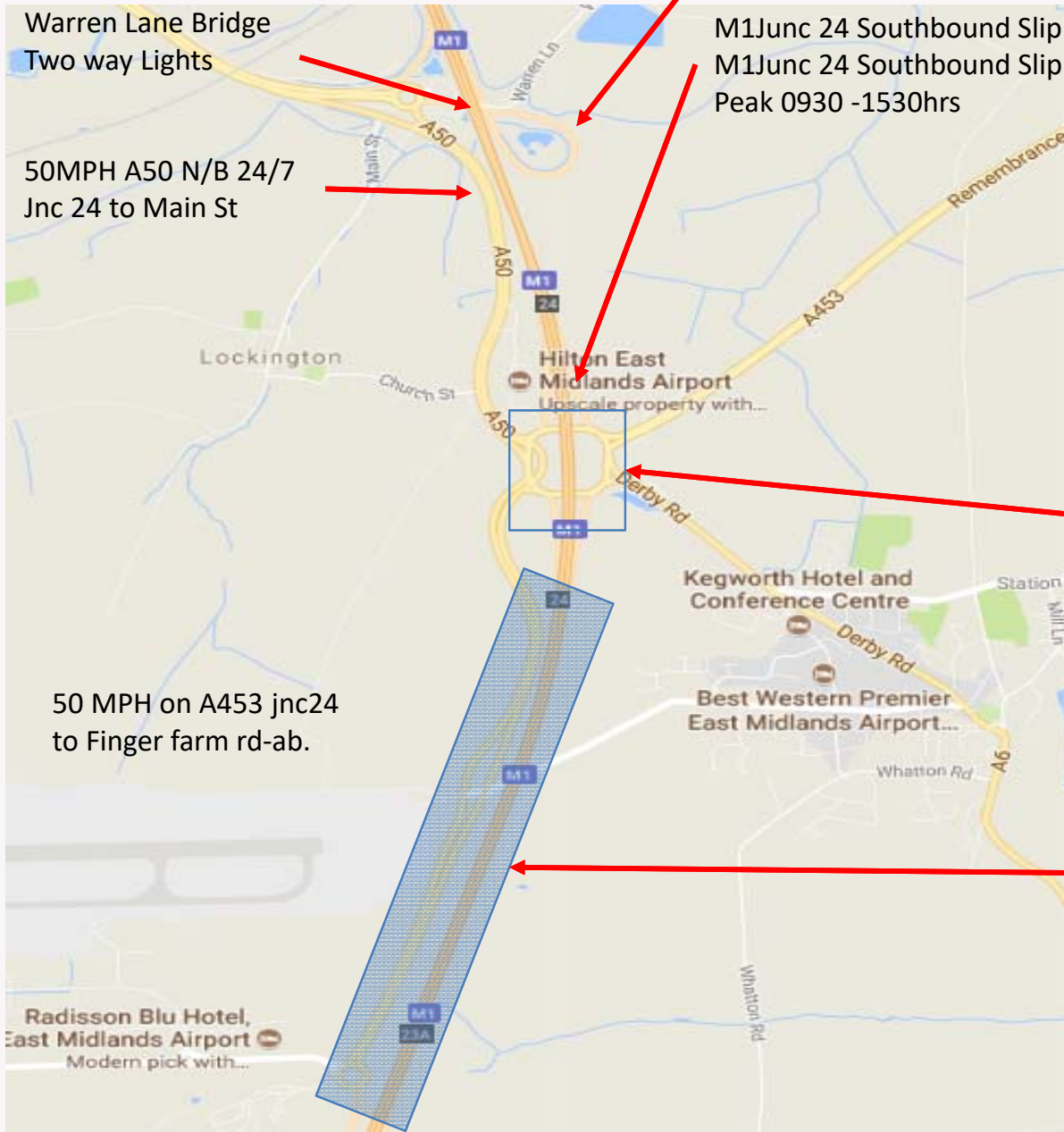

# Junction 24– W/C Mon 13<sup>th</sup> Nov 17

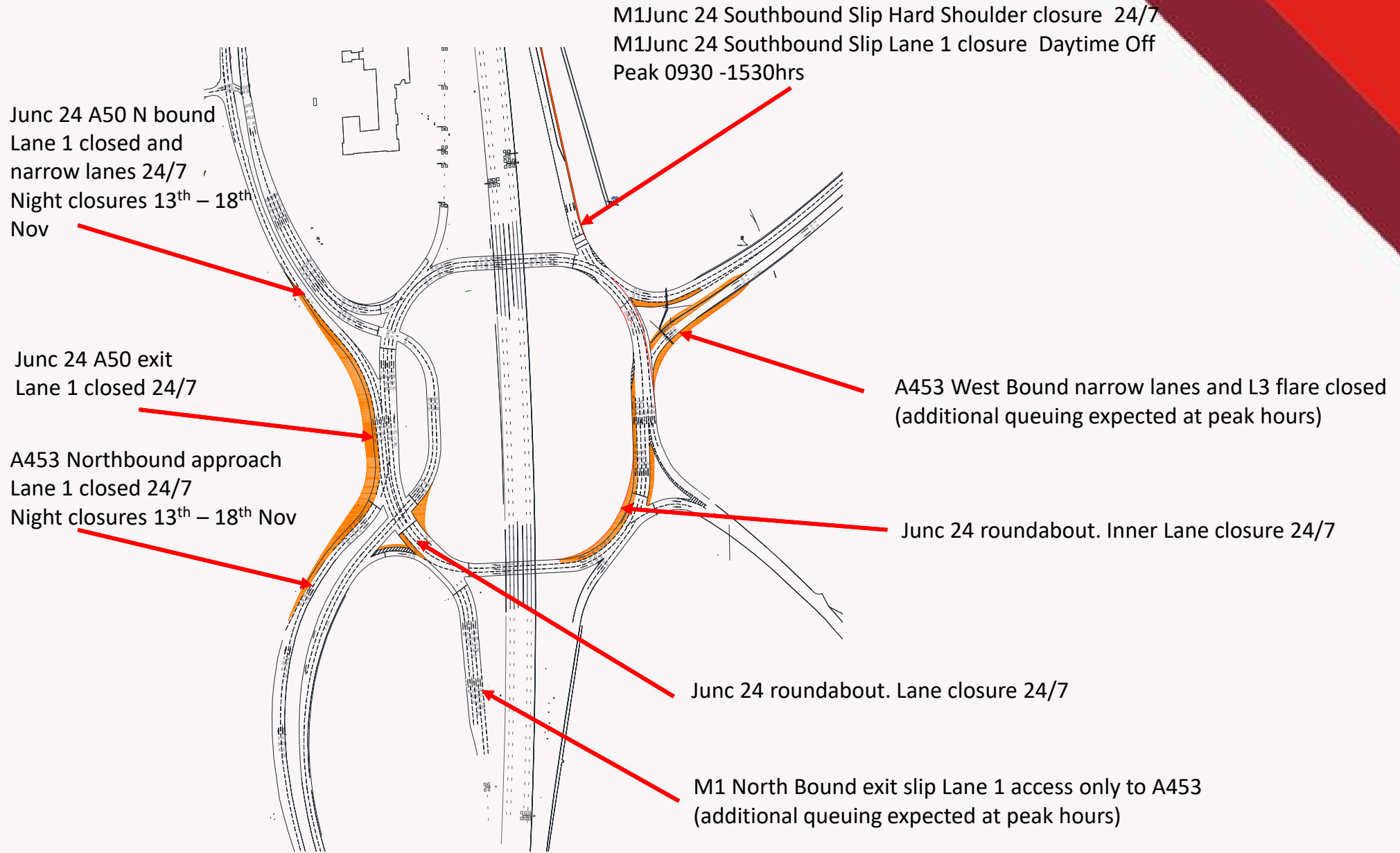

# EAST MIDLANDS GATEWAY – W/C 20th Nov Oct 17



M1 Junc 24a Southbound exit Slip lane 2 closure 24/7

Warren Lane Bridge  
Two way Lights

50MPH A50 N/B 24/7  
Jnc 24 to Main St

M1 Junc 24 Southbound Slip Hard Shoulder closure 24/7  
M1 Junc 24 Southbound Slip Lane 1 closure Daytime Off  
Peak 0930 -1530hrs

**Junc 24  
Roundabout.  
Various night time  
lane closures**

Junction 24 - see Enlarged sheet

50 MPH on A453 jnc24  
to Finger farm rd-ab.

A453 Open. Ashby Road closed.  
Night closures Mon 20th – Friday 24<sup>th</sup> Nov

Radisson Blu Hotel,  
East Midlands Airport  
Modern pick with...





# Junction 24– W/C Mon 20<sup>th</sup> Nov 17

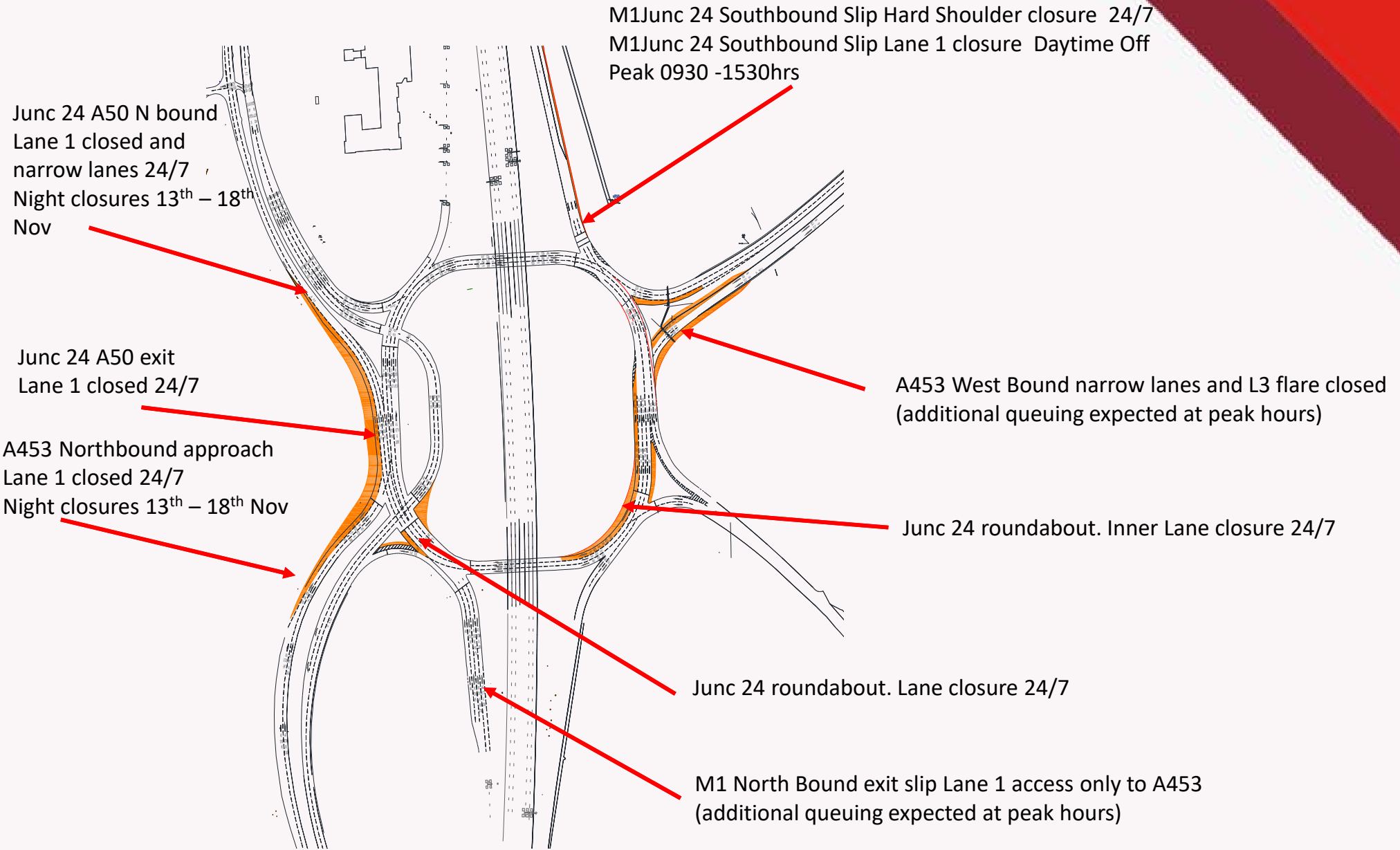

# Further Information

## Contacts,

Tel EMG Enquiries  
- 07514227681

E-mail  
- [emg-enquiries@winvic.co.uk](mailto:emg-enquiries@winvic.co.uk)

Web East Midlands Gateway specific  
- [www.eastmidlandsgateway.co.uk/community/travel.php](http://www.eastmidlandsgateway.co.uk/community/travel.php)

Web on the day of travel  
- [www.roadworks.org/](http://www.roadworks.org/)  
- [www.trafficengland.com/](http://www.trafficengland.com/)

## Project updates,

A project update if you wish to be added please e-mail request to above address.

This will include an overall project update and detailed traffic management plans for the forthcoming weeks including dates and times.

Please note all dates within this document are to be confirmed closer to the time